

SRT-WMSD
SRT-WSD ☐
SRT-WPMSD
SRT-WPSD ☐
SRTA-WMSD
SRTA-WSD ☐
SRTA-WPMSD
SRTA-WPSD ☐

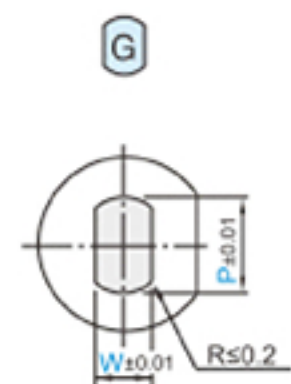

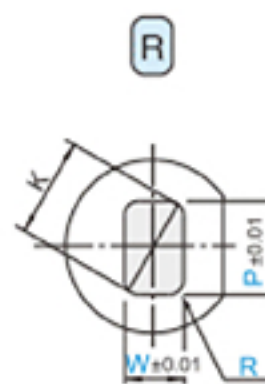

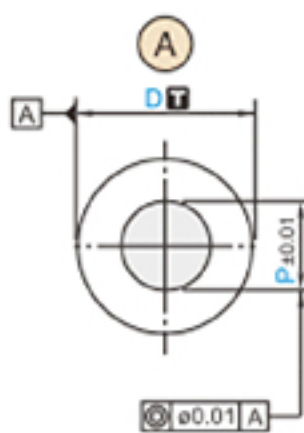

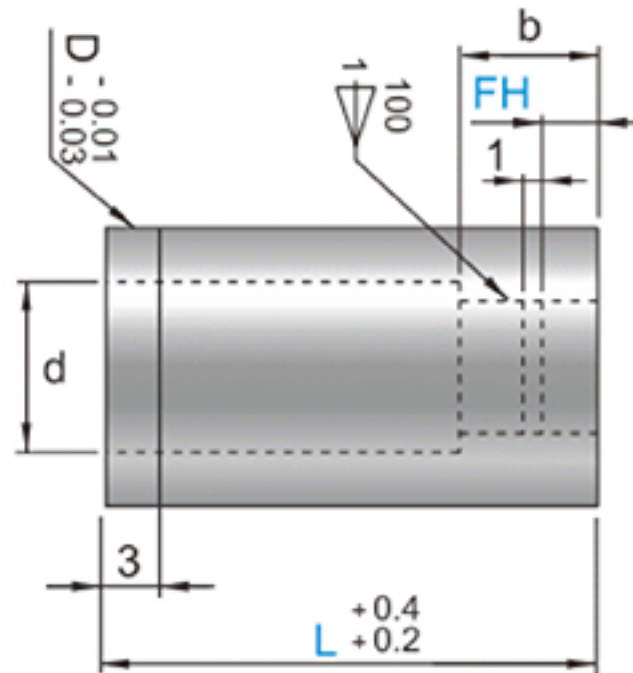
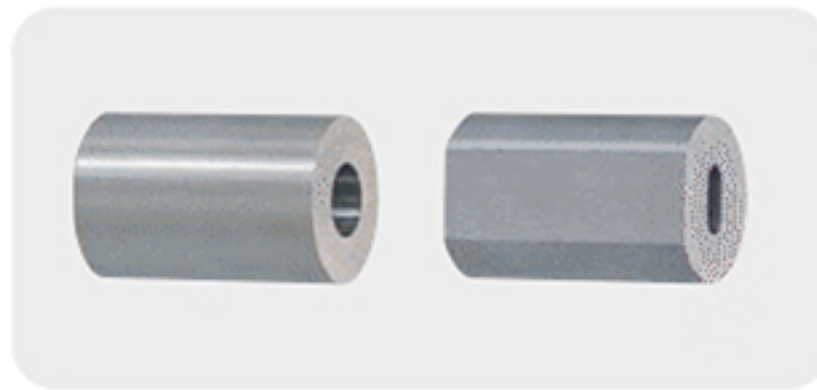



$$P - 0,4 \geq 1,5$$

$$K = \sqrt{(P-2R)^2 + (W-2R)^2} + 2R$$

P>W

$$\sqrt{P^2 - W^2} \geq 1.5$$

				Catalog No.
T	M	H	D	Type
D _{n5}	SKD11	60~63HRC	D8~25	 SRT-WSD□
			D6~25	 SRT-WMSD
	SKH51	61~64HRC	D5	 SRT-WPMSD
		64~67HRC	D6~25	 SRT-WPSD□
D ^{+0.005} ₀	SKD11	60~63HRC	D8~16	 SRTA-WSD□
			D6~16	 SRTA-WMSD
	SKH51	61~64HRC	D5	 SRTA-WPMSD
		64~67HRC	D4~16	 SRTA-WPSD□
			D6~16	 SRTA-WPSD□

